

B500006



主要技术特性(Main Specifications)

- ▶ 适用导线规格 (Applicable wire) : AWG22#~16#
- ▶ 适用基板厚度 (Applicable PC board thickness) : 1.2mm~1.6mm
- ▶ 温度范围 (Temperature range) : -25℃~+85℃
- ▶ 额定电压 (Voltage rating) : 250V AC, DC
- ▶ 额定电流 (Current rating) : 10A AC, DC
- ▶ 接触电阻 (Contact resistance) : $\leq 0.02\Omega$
- ▶ 绝缘电阻 (Insulation resistance) : $\geq 1000M\Omega$
- ▶ 耐压 (Withstanding voltage) : 1500V AC/minute

材料及电镀规格 Material and Finish

型号 Type	材料 Material	材料厚度 Material Thickness	电镀规格 Finish
插座 WAFER	塑胶 HOUSING	PA66 UL94V-0	N/A
	针PIN	黄铜 Barss	镀锡 Tin-plated
孔座 HOUSING	PA66 UL94V-0	—	N/A
端子 TERMINAL	锡青铜 Phosphor bronze	0.25mm	镀锡 Tin-plated

产品尺寸图 Product size chart

 单位: mm 一般公差: ± 0.20

TERMINAL

- B500006-4 1376348-1
B500006-4-I 1376347-1 高脚

安装尺寸 (Mounting measurement)

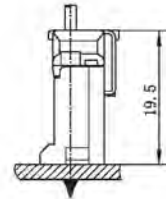
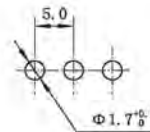
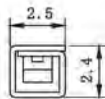
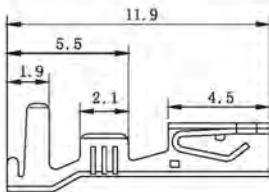

WAFER

- B500006-1-02 1376382-1
B500006-1-03 1376383-1

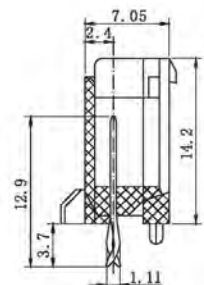
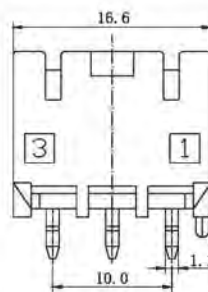
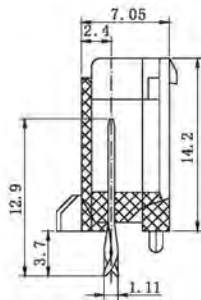
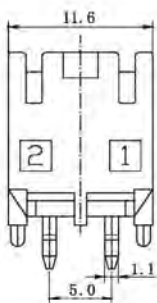

B500006

WAFER

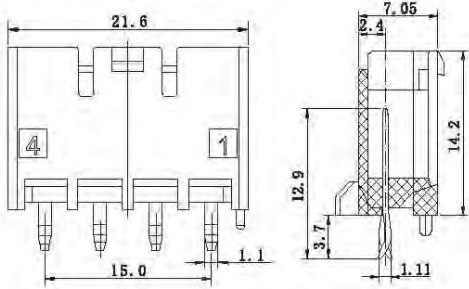
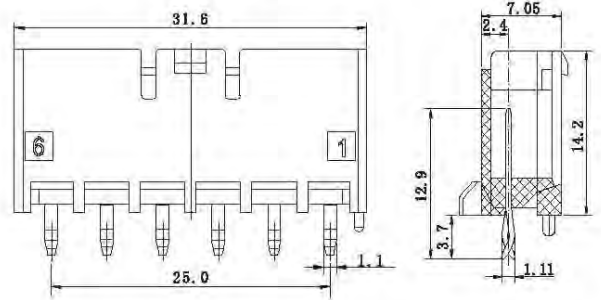
B500006-1-04 **1376384-1**

B500006-1-06 **1376385-1**

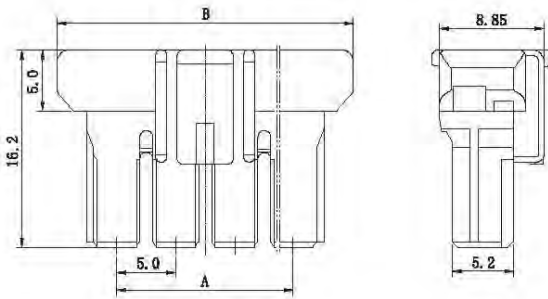
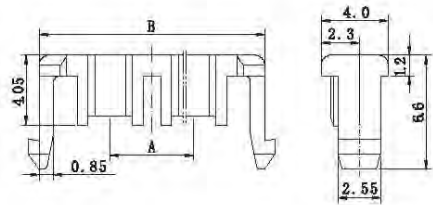
HOUSING

B500006-2

B500006-5

HOUSING

极数 Circuits	型号 Type	尺寸(Dimensions)mm		备注型号 P. S. Type
		A	B	
2	B500006-2-02	5.0	15.0	1376388-1
3	B500006-2-03	10.0	20.0	1376389-1
4	B500006-2-04	15.0	25.0	1376290-1
6	B500006-2-06	20.0	30.0	1376291-1

HOUSING

极数 Circuits	型号 Type	尺寸(Dimensions)mm		备注型号 P. S. Type
		A	B	
2	B500006-5-02	5.0	13.5	1376394-1
3	B500006-5-03	10.0	18.5	1376395-1
4	B500006-5-04	15.0	23.5	1376396-1
6	B500006-5-06	25.0	33.5	1376397-1